

# Road Barriers & Car Park Savers

# VE.500

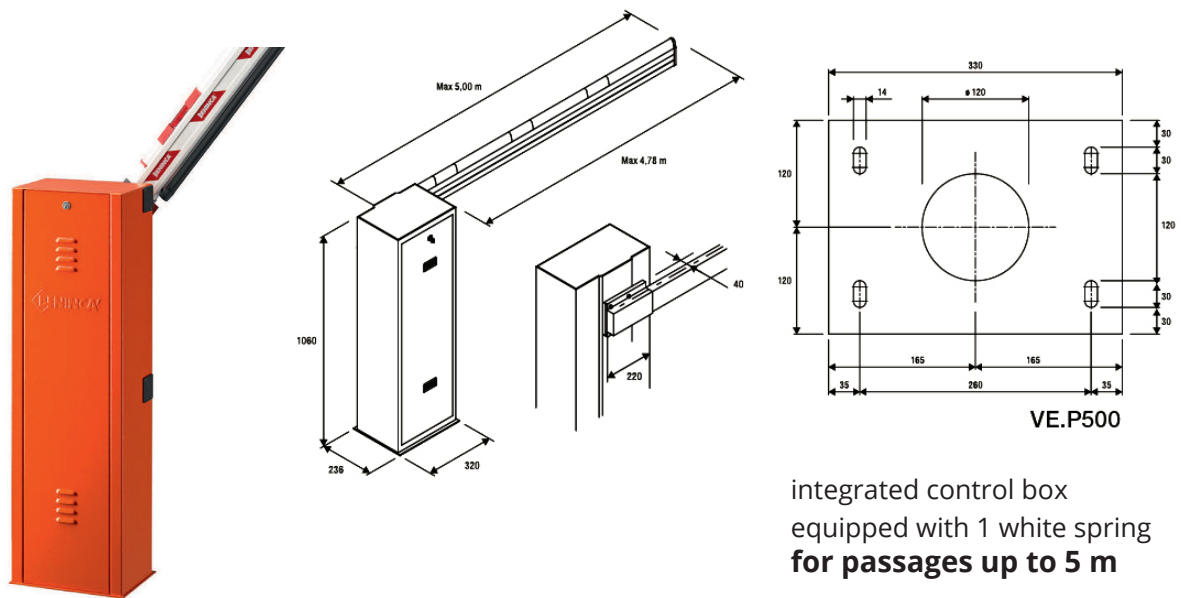

integrated control box  
equipped with 1 white spring  
for passages up to 5 m

## VE.500 - Specifications

Power Supply	<b>230 Vac (50-60Hz)</b>	Operation cycle	<b>intensive use</b>
Motor supply 24 Vdc	<b>24 Vdc</b>	Protection level	<b>IP44</b>
Max absorbed current	<b>1.6 A</b>	Operating temperature	<b>-20°C /+50°C</b>
Torque	<b>205 Nm</b>	Weight	<b>55.2 kg</b>
Opening time	<b>3" - 5"</b>		

Works with:

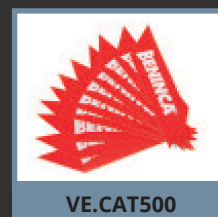
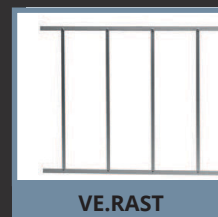

# EVA.5 5B

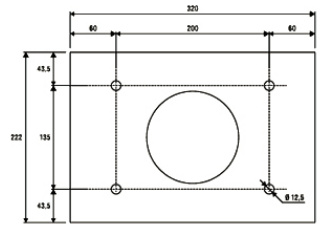
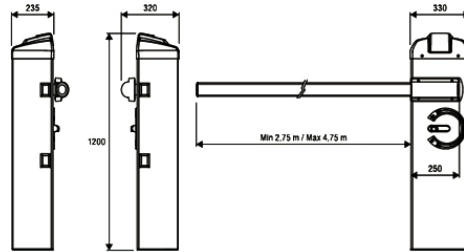

VE.PS

integrated control box  
with external release  
galvanized and painted casing and cover  
**for passages up to 5 m**

## EVA.5 5B - Specifications

Power Supply	100-250 Vac (50-60Hz)	Operation cycle	intensive use
Motor supply 24 Vdc	24 Vdc	Protection level	IP44
Max absorbed current	1.6 A	Operating temperature	-20°C / +50°C
Torque	205 Nm	Weight	55 kg
Opening time	3,5" - 6"		

Works with:

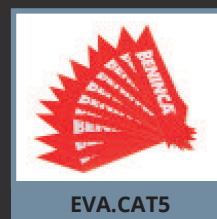
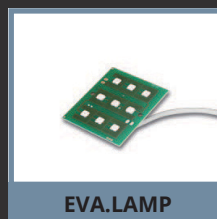
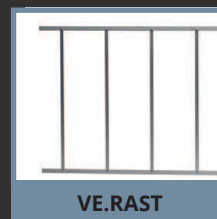
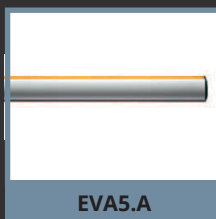

# EVA.7 5B

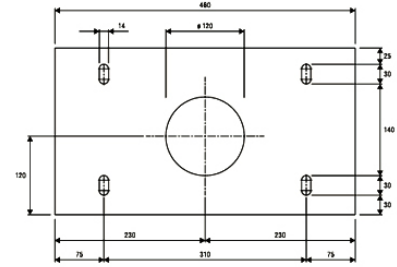
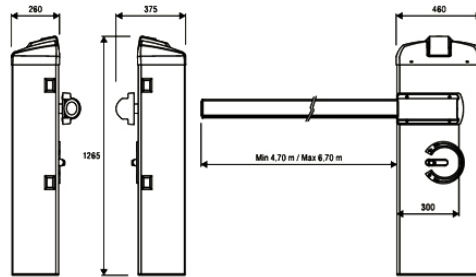

VE.P650

integrated control box  
with external release  
2 standard 480 mm springs included  
galvanized and painted casing and cover  
**for passages up to 7 m**

## EVA.7 5B - Specifications

Power supply	100-250 Vac (50-60Hz)	Opening time	3,5" - 6"
Motor supply	24 Vdc	Operation cycle	intensive use
Max absorbed current	1.6 A	Protection level	IP44
Power consumption in stand-by	40 mA (230Vac) 50 mA (115 Vac)	Operating temperature	-20°C /+50°C
Torque	285 Nm	Weight	105 kg

Works with:

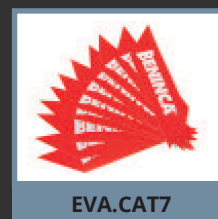
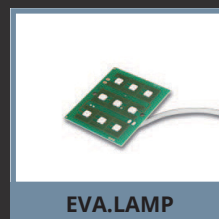
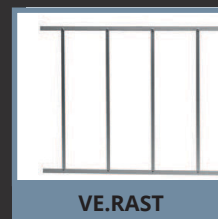
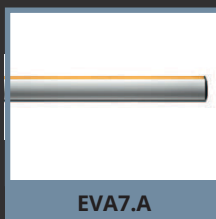

# NIUBA6

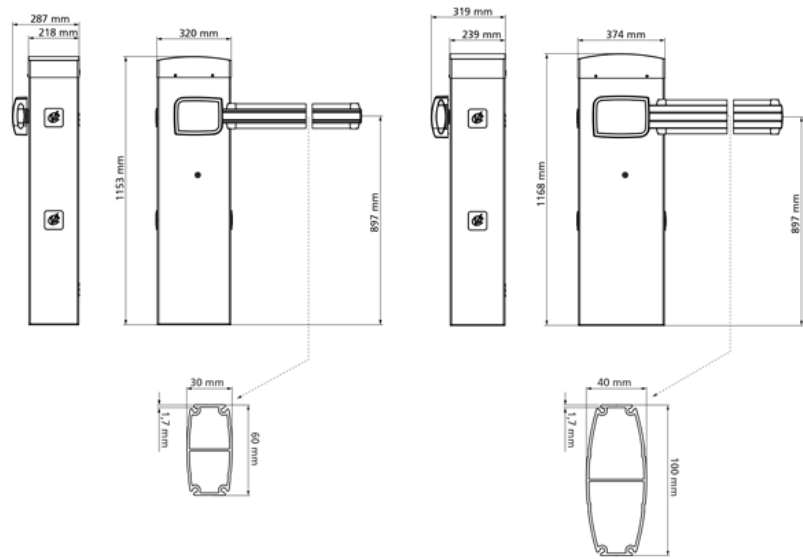

## NIUBA 6 - Specifications

Maximum power	<b>300 W</b>	Duty cycle	<b>80 - (200)%</b>
Power supply	<b>230V-50Hz</b>	Working temperature	<b>-20 °C / +55 °C</b>
Motor power supply	<b>24 Vdc</b>	Protection degree	<b>IP44</b>
Opening time	<b>3 ÷ 4 s</b>	Weight	<b>44 kg</b>

### Accessories for 4m Barriers



### Accessories for 6m Barriers



# VE.SOM

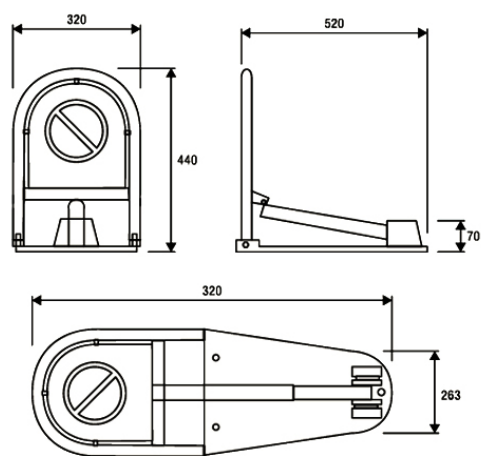

## VE.SOM - Specifications

Safeguard of private car park simple and quick to install.  
Manual version (VE.SOM).  
Easy and quick to install, it is suitable for every kind of urban environment.  
Weight: 6.8 kg

# VE.SOR

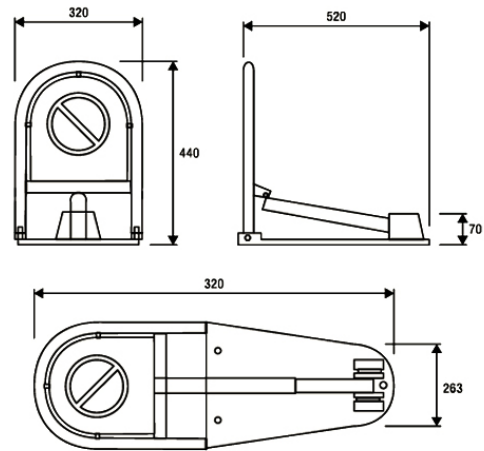

## VE.SOR - Specifications

Safeguard of private car park simple and quick to install.  
Automatic version (VE.SOR).  
Easy and quick to install, it is suitable for every kind of urban environment.

Operating way	<b>24 Vdc / automatic</b>	Operation cycle	<b>intensive use</b>
Power supply	<b>230Vac (50-60Hz)</b>	Working temperature	<b>-20 °C / +50 °C</b>
Motor power supply	<b>24 Vdc</b>	Protection degree	<b>IP54</b>
Max absorbed current	<b>2 A</b>	Weight	<b>7.5 kg</b>
Opening time	<b>9"</b>		

Works with:

