

Συρόμενη Πόρτα

KPONY

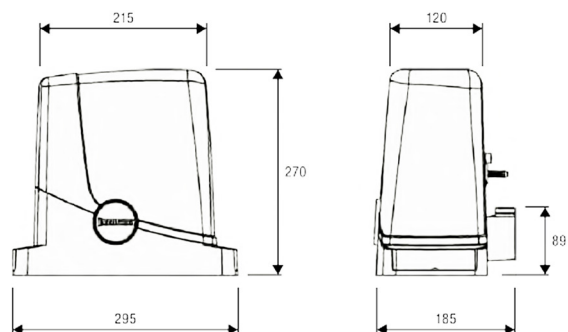

KIT:

- 1X PONY
- TRANSMITTER TO.GO 2VA

KPONY - Specifications

- 24 Vdc geared motor with built-in control unit and energy saving ESA SYSTEM
- Amperometric sensor obstacle detection system to prevent crushing
- Battery back up system ready
- The control unit is positioned in such a way as to make programming operations simple, easy and immediate

Power supply	230 Vac 50/60 Hz
Motor supply	230 Vac
Max absorbed current	0.6 A
Power consumption in stand-by	8 mA

Max Thrust	321 N
Opening speed	10m/min
Operation cycle	30%
Protection level	IP 44

Operating temperature	-20°C /+50°C
Max gate weight	650 kg
Driving gear for rack	M4 Z14
Weight	6.8 kg

Works with:



M4

BULL5M

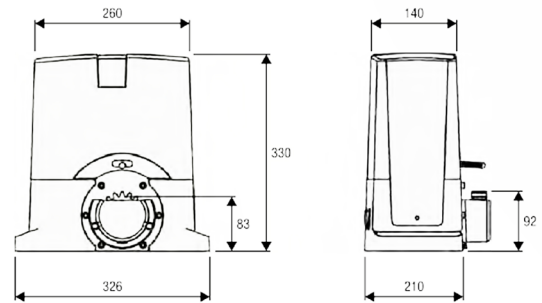

BULL5M - Specifications

- Electromechanical 230 Vac geared motor with built-in control unit
- Optional encoder connection using MAG.E accessory
- The encoder device ensures crush prevention and precision in the gate moving phases
- Full metal release system
- Magnetic limit switches accessory available (MLS)

Power supply	230 Vac 50/60 Hz	Max Thrust	650 N	Operating temperature	-20°C /+50°C
Motor supply	230 Vac	Opening speed	10,5m/min	Max gate weight	500 kg
Max absorbed current	1.3 A	Operation cycle	30%	Driving gear for rack	M4 Z18
		Protection level	IP 44	Weight	10.6 kg

Works with:



M4

BULL5M-SC

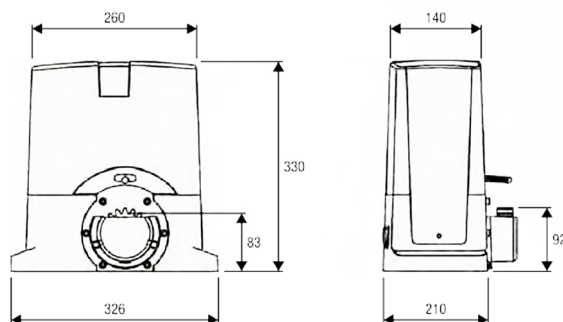

BULL5M-SC - Specifications

Electromechanical 230 Vac geared motor with built-in control unit. Optional encoder connection using MAG.E accessory. The encoder device ensures crush prevention and precision in the gate moving phases. Full metal release system. Magnetic limit switches accessory available (MLS).

Power supply	230 Vac 50/60 Hz
Motor supply	230 Vac
Max absorbed current	1.3 A

Max Thrust	650 N
Opening speed	10,5m/min
Operation cycle	30%
Protection level	IP 44

Operating temperature	-20°C /+50°C
Max gate weight	500 kg
Driving gear for rack	M4 Z18
Weight	10.6 kg

Works with:



CP.CORE



M4

BULL8M

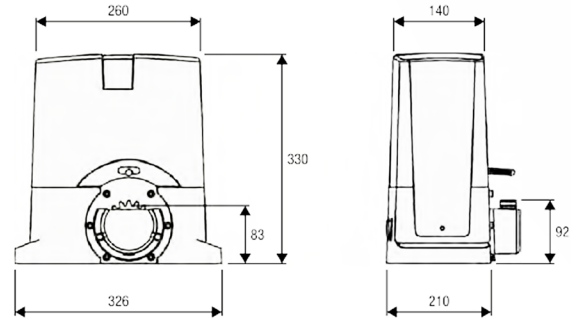

BULL8M - Specifications

- Electromechanical 230 Vac geared motor with built-in control unit and encoder
- The encoder device ensures crush prevention and precision in the gate moving phases
- Full metal release system
- Version with magnetic limit switches available (BULL8M.S)

Power supply	230 Vac 50/60 Hz
Motor supply	230 Vac
Max absorbed current	2.6 A

Max Thrust	940 N
Opening speed	10,5m/min
Operation cycle	30%
Protection level	IP 44
Magnetic Limit Switches	NO

Operating temperature	-20°C /+50°C
Max gate weight	800 kg
Driving gear for rack	M4 Z18
Weight	11.4 kg

Works with:

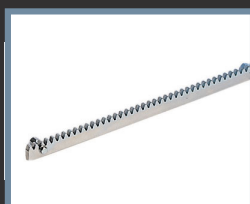

M4

BULL8M-SC

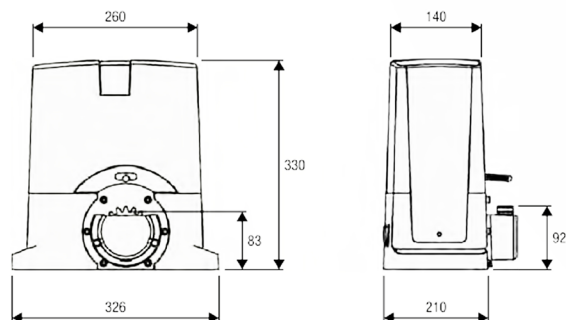

BULL8M-SC - Specifications

- Electromechanical 230 Vac geared motor with built-in control unit and encoder
- The encoder device ensures crush prevention and precision in the gate moving phases
- Full metal release system
- Version with magnetic limit switches available (BULL8M.S)

Power supply	230 Vac 50/60 Hz
Motor supply	230 Vac
Max absorbed current	2.6 A

Max Thrust	940 N
Opening speed	10,5m/min
Operation cycle	30%
Protection level	IP 44
Magnetic Limit Switches	NO

Operating temperature	-20°C /+50°C
Max gate weight	800 kg
Driving gear for rack	M4 Z18
Weight	11.4 kg

Works with:

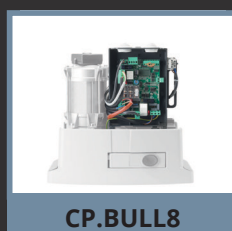

BULL10M/20M

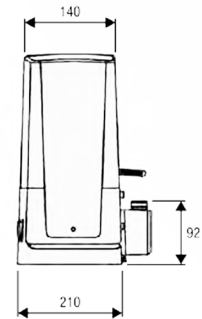
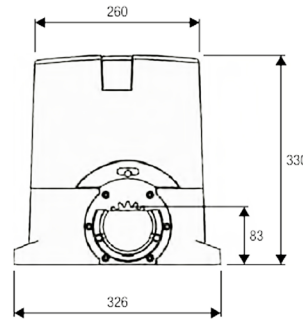

BULL10M/20M - Specifications

Irreversible electromechanical geared motor equipped with encoder available in 230 Vac or 24 Vdc version. Full metal release system.

Power supply	230 Vac 50/60 Hz
Motor supply	230 Vac
Max absorbed current	1.6 A

Max Thrust	1000 N
Opening speed	10,5m/min
Operation cycle	40%
Protection level	IP 44
Magnetic Limit Switches	NO

Operating temperature	-20°C /+50°C
Max gate weight	1000 kg
Driving gear for rack	M4 Z18
Weight	18.7 kg

Works with:



M4

BULL20T

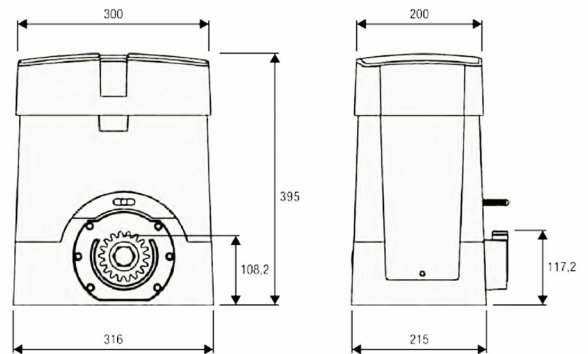

BULL20T - Specifications

Irreversible electromechanical geared motor equipped with encoder available in 230 Vac or 24 Vdc version. Full metal release system.

Power supply	400 Vac 50/60 Hz
Motor supply	400 Vac
Max absorbed current	1.7 A

Max Thrust	2000 N
Opening speed	10,5m/min
Operation cycle	intensive use
Protection level	IP 44
Magnetic Limit Switches	NO

Operating temperature	-20°C /+50°C
Max gate weight	2000 kg
Driving gear for rack	M4 Z18
Weight	21.6 kg

Works with:

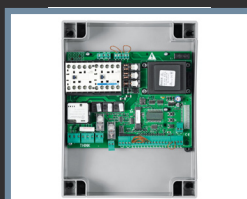

THINK

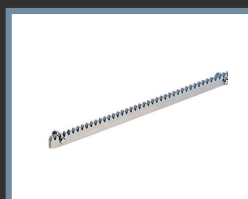

M4



WALLY 1U



ONE.2WB

ALFARISS

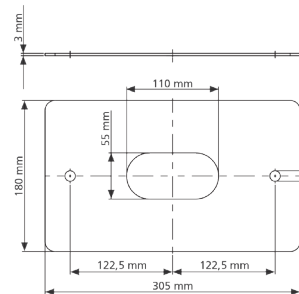
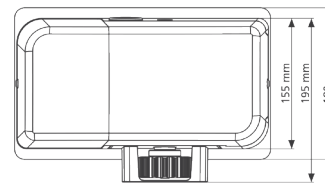
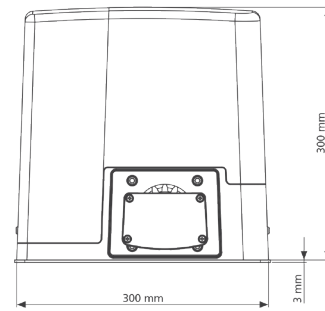

ALFARISS - Specifications

24V irreversible electromechanical rack actuator motor reducer for sliding gates weighing up to 300 kg

Gate maximum weight	300 kg	Gate maximum speed	0.14 ÷ 0.26 m/s	Working temperature	-20 ÷ +55°C
Power supply	230G/50Hz	Maximum thrust	330N	Weight	7.5 kg
Maximum power	150 W	Duty cycle	50%	Protection degree	IP 44
Full load current	0.7 A	Pinion	M4-Z16	Maximum load on 24 Vac accessories	7 W

Works with:



M4

GOLD400



KIT:

- 1X Receiver MR2-U-433
- 2X Transmitter PHOX2

GOLD400 - Specifications

Works with:

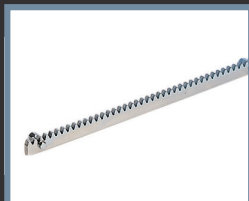

M4

GOLD800



KIT:

- 1X Receiver MR2-U-433
- 2X Transmitter PHOX2

GOLD800 - Specifications

Works with:

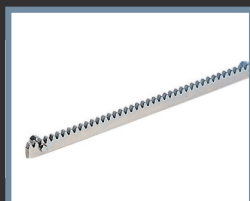

M4

